

Alessandro Boulevard Corridor Project

Rezoning to R30 & CC - Area 4 & Area 5

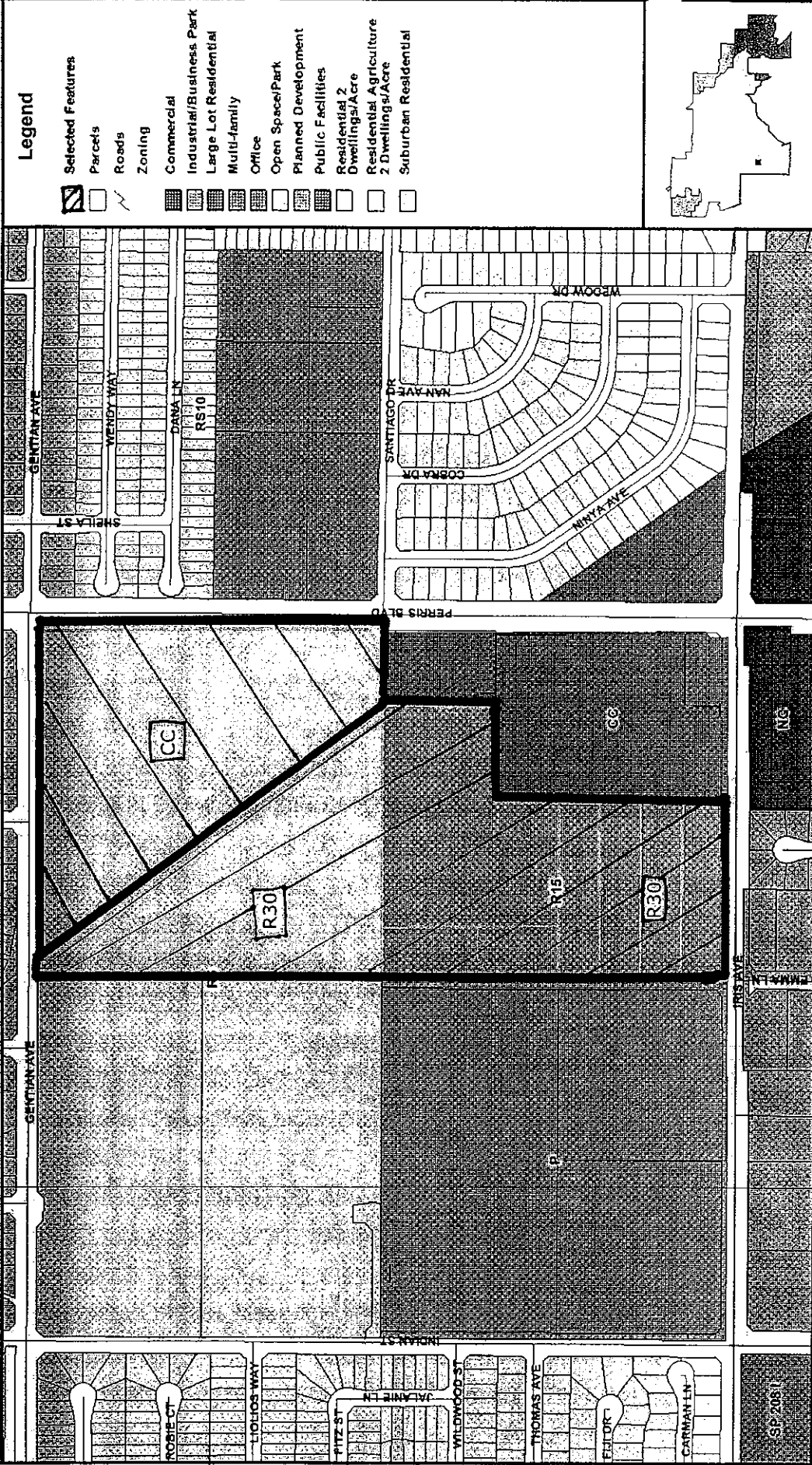

Legend

Symbol	Description
[Hatched Box]	Selected Features
[Thin Line]	Parcels
[Thick Line]	Roads
[Wavy Line]	Zoning
[Diagonal Lines]	Commercial
[Cross-hatch]	Industrial/Business Park
[Vertical Lines]	Large Lot Residential
[Horizontal Lines]	Multi-Family
[Dotted]	Office
[Stippled]	Open Space/Park
[Diagonal Lines (other)]	Planned Development
[Vertical Lines (other)]	Public Facilities
[Horizontal Lines (other)]	Residential 2 Dwellings/Acre
[Dotted (other)]	Residential Agriculture
[Stippled (other)]	2 Dwellings/Acre
[Cross-hatch (other)]	Suburban Residential

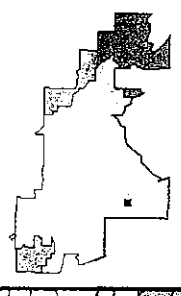

Powered By GeoSmart.net

Printed: 1/29/2013 10:27:18 AM

City of Moreno Valley
 14177 Frederick Street
 Moreno Valley, CA 92553

DISCLAIMER: The information shown on this map was compiled from the Riverside County GIS and the City of Moreno Valley GIS. The land base and facility information on this map is for display purposes only and should not be relied upon without independent verification as to its accuracy. Riverside County and City of Moreno Valley will not be held responsible for any claims, losses, or damages resulting from the use of this map.



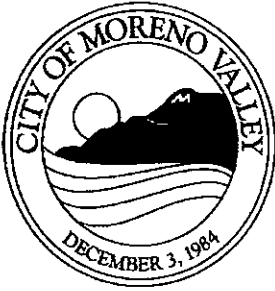

NOTICE OF PLANNING COMMISSION PUBLIC HEARING

THE PLANNING COMMISSION WILL CONSIDER TWO GENERAL PLAN AMENDMENTS (PA11-0028 & PA12-0046), TWO CHANGES OF ZONES (PA11-0029 & PA12-0047), AND MUNICIPAL CODE AMENDMENT (PA11-0030) RELATED TO THE ALESSANDRO BOULEVARD CORRIDOR IMPLEMENTATION PROJECT.

The City of Moreno Valley used grant funds rewarded by SCAG's Compass Blueprint for "Phase II of the implementation of the Alessandro Boulevard Corridor Demonstration Project" (The Alessandro Boulevard Corridor Focus Study - Phase I was funded by SCAG's Compass Blueprint program in February 2010). Phase II includes rezoning areas along Alessandro Boulevard to R30 (Residential up to 30 units per acre), commercial rezoning of a parcel at the southwest corner of Perris Boulevard and Gentian Avenue and the creation an overlay district including parcels along Alessandro Boulevard that were identified suitable for inclusion in the Multiple-Use Overlay Districts. The R30 rezoning will also provide consistency with the City's certified Housing Element.

This item will not have a significant effect on the environment and approval of a Mitigated Negative Declaration is recommended.

A Community Information Meeting regarding the "The Alessandro Boulevard Corridor Implementation Plan" will be held on Thursday, March 7, 2013 5:00 P.M. – 7:00 P.M. at:

**City Hall Council Chamber
14177 Frederick Street.
Moreno Valley, CA 92552-0805**

The Planning Commission may consider any appropriate modifications or alternatives to the amendment or the environmental determination. Any person concerned about the proposal may submit written comments to the Planning Division prior to the hearing date listed below. Any person may appear and be heard in support or opposition to the project or the environmental determination at the time of the hearing. Any person interested in the proposed project may contact Claudia Manrique, Associate Planner at (951) 413-3225 in the Community & Economic Development Department at 14177 Frederick Street, Moreno Valley, California, during normal business hours (7:30 a.m. to 5:30 p.m., Monday – Thursday).

If you challenge any of these items in court, you may be limited to raising only those issues you or someone else raised at the Public Hearing described in this notice, or in written correspondence delivered to the **Planning Commission on or before the following meeting date:**

**Thursday, March 14, 2013
7:00 P.M. or thereafter
City Hall Council Chamber
14177 Frederick Street
Moreno Valley, CA 92552-0805**

316030007
BERMUDEZ, KATRINA
24623 IRIS AVE
MORENO VALLEY 92551

316030007
BERMUDEZ, SAUL
24623 IRIS AVE
MORENO VALLEY 92551

316030008
BROYLES, GENEVA R
16085 EMMA LN
MORENO VALLEY 92551

316030014
2TES FAMILY TRUST
P O BOX 7000 318
ROLLING HILLS ESTATE CA 90274

316030020
OOTEN, MINEORA R
24771 IRIS AVE
MORENO VALLEY CA 92553

316030020
OOTEN, JOHN
24771 IRIS AVE
MORENO VALLEY CA 92553

316030021
OOTEN, MINEORA R
24771 IRIS AVE
MORENO VALLEY CA 92553

316030021
OOTEN, JOHN
24771 IRIS AVE
MORENO VALLEY CA 92553

316040006
LUGO, ARTURO ALVAREZ
16039 GERANIUM CT
MORENO VALLEY 92551

316040007
AMEZCUA, LEANDRO C
16027 GERANIUM CT
MORENO VALLEY 92551

316040008
HERNANDEZ, RICHARD C
16015 GERANIUM CT
MORENO VALLEY CA 92553

316040008
HERNANDEZ, BARBARA
16015 GERANIUM CT
MORENO VALLEY CA 92553

316040009
HUGHES, DAWN E
16001 GERANIUM CT
MORENO VALLEY 92551

316040009
HUGHES, MARLENE J
16001 GERANIUM CT
MORENO VALLEY 92551

316040010
CHATMAN, RODNEY K
16000 GERANIUM CT
MORENO VALLEY 92551

316040010
DHOUTI, DEANNA
16000 GERANIUM CT
MORENO VALLEY 92551

316040011
MARTIN, EULA M
16016 GERANIUM CT
MORENO VALLEY 92551

316040011
MARTIN, JERRY W
16016 GERANIUM CT
MORENO VALLEY 92551

316040012
AHMAD, MOHAMMAD
16028 GERANIUM CT
MORENO VALLEY 92551

316040012
AHMAD, FAIZA
16028 GERANIUM CT
MORENO VALLEY 92551

485111007
MPLC LEGACY 140 PARTNERS
4100 NEWPORT PL STE 400
NEWPORT BEACH CA 92660

485111008
MPLC LEGACY 140 PARTNERS
4100 NEWPORT PL STE 400
NEWPORT BEACH CA 92660

485111009
MPLC LEGACY 140 PARTNERS
4100 NEWPORT PL STE 400
NEWPORT BEACH CA 92660

485111010
MPLC LEGACY 140 PARTNERS
4100 NEWPORT PL STE 400
NEWPORT BEACH CA 92660

485111011
MPLC LEGACY 140 PARTNERS
4100 NEWPORT PL STE 400
NEWPORT BEACH CA 92660

485111012
MPLC LEGACY 140 PARTNERS
4100 NEWPORT PL STE 400
NEWPORT BEACH CA 92660

485111013
MPLC LEGACY 140 PARTNERS
4100 NEWPORT PL STE 400
NEWPORT BEACH CA 92660

485111014
MPLC LEGACY 140 PARTNERS
4100 NEWPORT PL STE 400
NEWPORT BEACH CA 92660

485111015
MPLC LEGACY 140 PARTNERS
4100 NEWPORT PL STE 400
NEWPORT BEACH CA 92660

485111016
MPLC LEGACY 140 PARTNERS
4100 NEWPORT PL STE 400
NEWPORT BEACH CA 92660

485111017
MPLC LEGACY 140 PARTNERS
4100 NEWPORT PL STE 400
NEWPORT BEACH CA 92660

485112002
MPLC LEGACY 140 PARTNERS
4100 NEWPORT PL STE 400
NEWPORT BEACH CA 92660

485112005
MPLC LEGACY 140 PARTNERS
4100 NEWPORT PL STE 400
NEWPORT BEACH CA 92660

485112008
MPLC LEGACY 140 PARTNERS
4100 NEWPORT PL STE 400
NEWPORT BEACH CA 92660

485112023
MPLC LEGACY 140 PARTNERS
4100 NEWPORT PL STE 400
NEWPORT BEACH CA 92660

485113012
MPLC LEGACY 140 PARTNERS
4100 NEWPORT PL STE 400
NEWPORT BEACH CA 92660

485114014
MPLC LEGACY 140 PARTNERS
4100 NEWPORT PL STE 400
NEWPORT BEACH CA 92660

485114017
MPLC LEGACY 140 PARTNERS
4100 NEWPORT PL STE 400
NEWPORT BEACH CA 92660

485114020
MPLC LEGACY 140 PARTNERS
4100 NEWPORT PL STE 400
NEWPORT BEACH CA 92660

485121011
CITY OF MORENO VALLEY
P O BOX 88005
MORENO VALLEY CA 92552

485111018
MPLC LEGACY 140 PARTNERS
4100 NEWPORT PL STE 400
NEWPORT BEACH CA 92660

485112003
MPLC LEGACY 140 PARTNERS
4100 NEWPORT PL STE 400
NEWPORT BEACH CA 92660

485112006
MPLC LEGACY 140 PARTNERS
4100 NEWPORT PL STE 400
NEWPORT BEACH CA 92660

485112017
CITY OF MORENO VALLEY
P O BOX 88005
MORENO VALLEY CA 92552

485113010
MPLC LEGACY 140 PARTNERS
4100 NEWPORT PL STE 400
NEWPORT BEACH CA 92660

485114012
MPLC LEGACY 140 PARTNERS
4100 NEWPORT PL STE 400
NEWPORT BEACH CA 92660

485114015
MPLC LEGACY 140 PARTNERS
4100 NEWPORT PL STE 400
NEWPORT BEACH CA 92660

485114018
MPLC LEGACY 140 PARTNERS
4100 NEWPORT PL STE 400
NEWPORT BEACH CA 92660

485114021
MPLC LEGACY 140 PARTNERS
4100 NEWPORT PL STE 400
NEWPORT BEACH CA 92660

485121012
CITY OF MORENO VALLEY
P O BOX 88005
MORENO VALLEY CA 92552

485112001
MPLC LEGACY 140 PARTNERS
4100 NEWPORT PL STE 400
NEWPORT BEACH CA 92660

485112004
MPLC LEGACY 140 PARTNERS
4100 NEWPORT PL STE 400
NEWPORT BEACH CA 92660

485112007
MPLC LEGACY 140 PARTNERS
4100 NEWPORT PL STE 400
NEWPORT BEACH CA 92660

485112022
MPLC LEGACY 140 PARTNERS
4100 NEWPORT PL STE 400
NEWPORT BEACH CA 92660

485113011
MPLC LEGACY 140 PARTNERS
4100 NEWPORT PL STE 400
NEWPORT BEACH CA 92660

485114013
MPLC LEGACY 140 PARTNERS
4100 NEWPORT PL STE 400
NEWPORT BEACH CA 92660

485114016
MPLC LEGACY 140 PARTNERS
4100 NEWPORT PL STE 400
NEWPORT BEACH CA 92660

485114019
MPLC LEGACY 140 PARTNERS
4100 NEWPORT PL STE 400
NEWPORT BEACH CA 92660

485114022
MPLC LEGACY 140 PARTNERS
4100 NEWPORT PL STE 400
NEWPORT BEACH CA 92660

485121014
MPLC LEGACY 140 PARTNERS
4100 NEWPORT PL STE 400
NEWPORT BEACH CA 92660

